

LOUVOLITE

OneTouch® 1.2Nm DC TUBULAR MOTOR

WITH RECHARGEABLE BUILT IN LITHIUM-ION BATTERY

Part Number: R1912

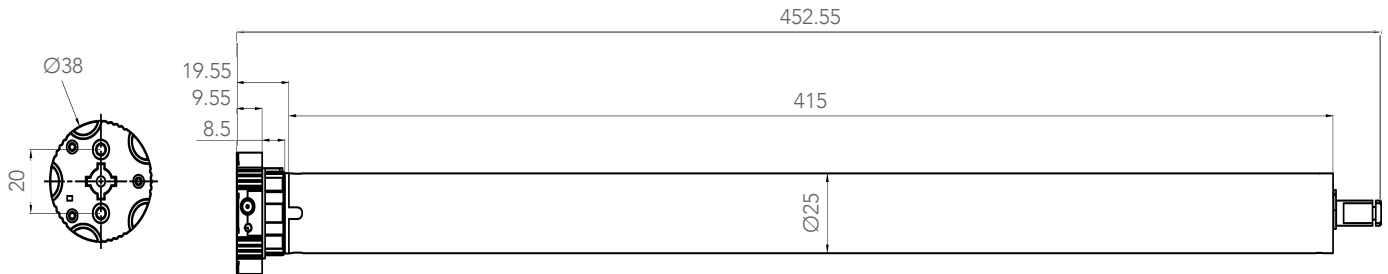

Battery Powered



Solar Powered

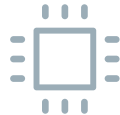

Electronic Limit



433.92MHz



Favourite Position



Power Button



Soft Start and Stop

FEATURES

- 3.5kg maximum weight capacity.
- Simple to program and set.
- 4 additional mid limit settings.
- Rechargeable built in Lithium-ion battery.
- Optional - Solar panel charger.
- Minimum blind size 510mm
- Works with Louvolite Home Hub
- 3 year warranty

SPECIFICATIONS

Rated Voltage	DC7.4V
Rated Torque	1.2Nm
Max Run Time	No limit
Speed	25rpm
Radio Frequency	433.92MHz
RF Modulation	ASK
IP Rating	IP44
Limit Switch Type	Electronic
Amps	900mA
Battery Size/Type	2600mAH
Temp Working Range	14°F to 122°F (-10°C to 50°C)
Insulation Class	III
Sound Level	30dB

COMPATIBLE TUBES

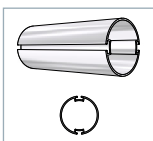

40mm
R8024

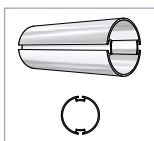

40mm HD
R8025-5.8

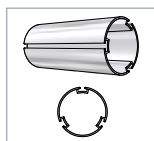

45mm
R8027

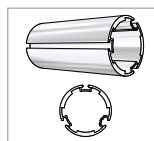

45mm HD
R8029

LOUVOLITE

APPLICATIONS



Roller



Roman



Vision



Visage

CONTROL OPTIONS

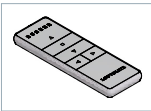

Remotes



Home Hub

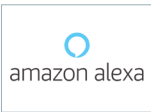
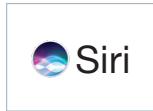

amazon alexa



Control4



SAVANT



Works with IFTTT



works with the Google Assistant



indigo domotics

CHARGING OPTIONS



Power Cable

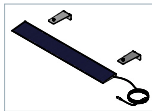

Solar Panel

ACCESSORY INDEX

8.4V Lithium battery charger
R1718-AUS-PLUG

Lithium Battery Solar Panel Charger 15.3V 1.55W (+/-5%)
R1930

12V Lithium Battery Extension Cable 200mm
R1714-200

1 Channel Remote
R1920-1CH

2 Channel Remote
R1921-2CH

6 Channel Remote
R1922-6CH

16 Channel Remote
R1924-16CH

40mm Motor Plate/ Crown/ Drive/ 40mm Brackets
and 40mm Idle End

- R1990-40-WH-1.2N
- R1990-40-BG-1.2N
- R1990-40-BK-1.2N
- R1990-40-7016-1.2N

45mm Motor Plate/ Crown/ Drive/ 45mm Brackets
and 45mm Idle End

- R1990-45-WH-1.2N

Louvolite One Touch® Wi-Fi Hub
R1764-AU